

# PowerByte



## Interactive Setup Guide

Version 1.5

**Start Setup**

[< Back](#)

# Main Menu

1. [Before You Start](#)
2. [How to Charge](#)
3. [FM Radio](#)
4. [SD Card Player](#)
5. [USB Stick Player](#)
6. [Bluetooth Speaker](#)
7. [Troubleshooting and FAQs](#) ↗
8. [Register Product](#) ↗
9. [Contact Us](#)
10. [Rate this Guide](#) ↗

Next

< Back

Back to  
Menu



## 1. Before You Start

☒ The PowerByte works as an FM radio, microSD card player, USB Stick Player, and Bluetooth speaker.

⚠ Supports **MP3**, **WAV**, and **WMA** files with up to **32GB** storage (card or flash drive).

☒ The unit will only activate the Micro SD, USB or AUX mode **after** it detects a connected audio source.

Got it

< Back

Back to  
Menu



## 2. How to Charge

The battery icon flashes while charging and stops when full (about **2** hours).

☒ Charging requirements: 5V / 2~3A (USB-C).

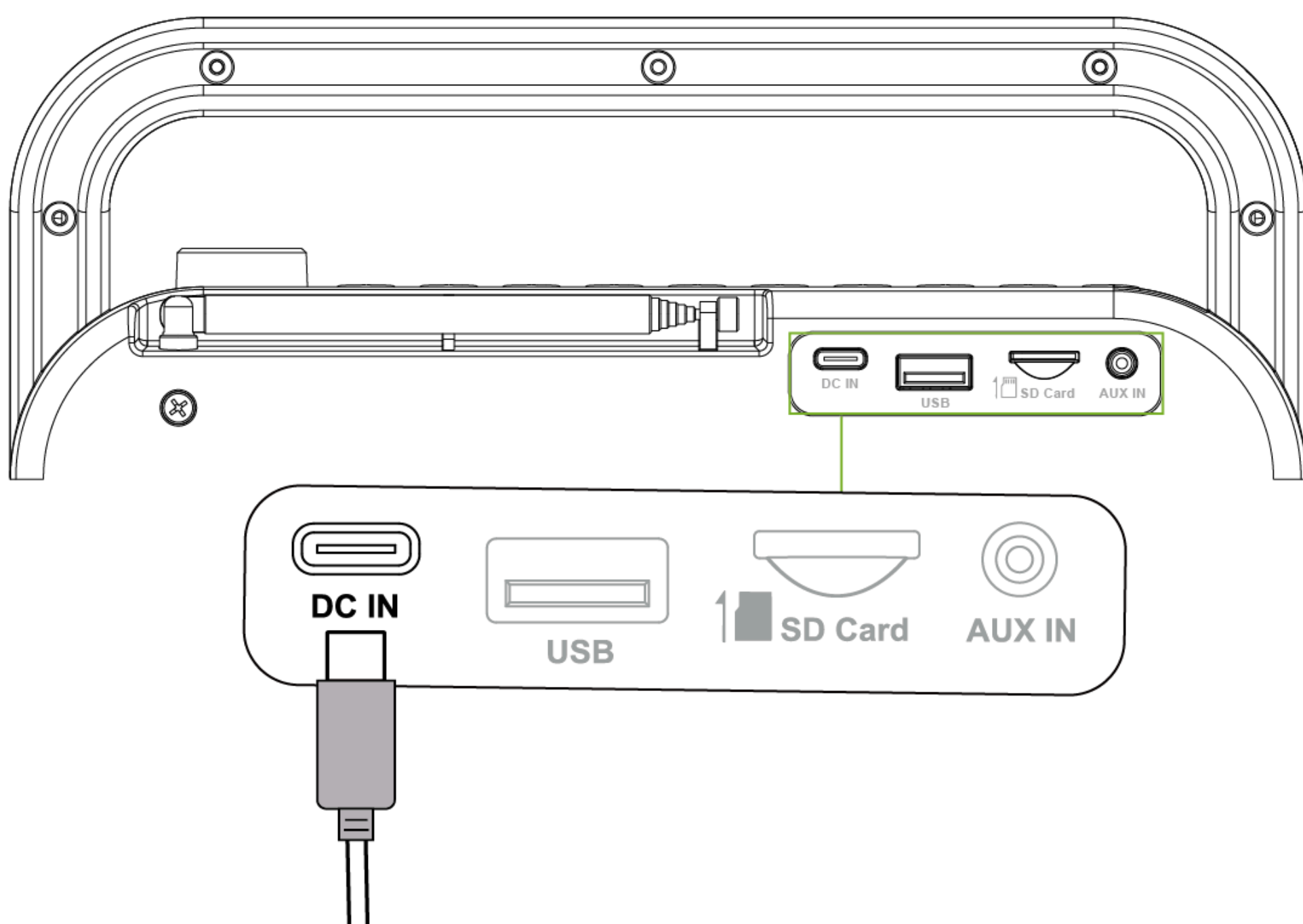

Got it

< Back

Back to  
Menu



# I would like to use as



FM Radio

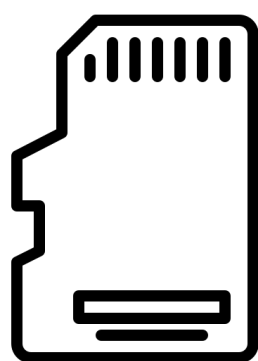

SD Card  
Player



USB Stick  
Player

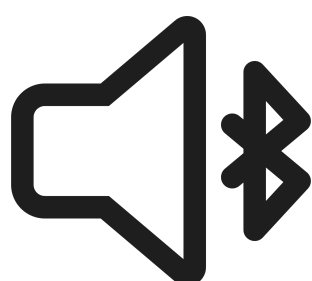

BT Speaker

< Back

Back to  
Menu



## 3. FM Radio

### 3.1 Switch to FM mode

1☒ Turn the knob to **ON** — the screen will light up.

2☒ Device will auto-search stations on first power-on. If not, press and hold FM button.



Continue

< Back

Back to  
Menu



## 3. FM Radio

### 3. 2 Search Channels

1☒The device will scan and save all available stations. (Takes about **2** minutes.)

2☒When done, it will tune to the **first** station found. Use the **SEEK>** button to scroll through saved stations.

Got it

Troubleshoot

< Back

Back to  
Menu



# Reduce Static & Improve Reception

☒ FM signals can be weak in remote areas or enclosed rooms.

⚠ Minimise interference—keep phones, TVs, and other electrical devices away.

☒ Use the antenna & fully extend it.

Continue

Need help



< Back

Back to  
Menu



## 3. FM Radio

### 3. 3 Preset Channel

↓ To save a favorite, hold any number key (1–9) until “Channel Saved” appears. Next time, press that number to go straight to the station.



Continue

< Back

Back to  
Menu



## 4. SD Card Player

### 4.1 Insert MicroSD card

- Maximum storage capacity for a MicroSD card: **32GB**.
- Supported file formats: **MP3, WAV, WMA**.
- Push the card in until it clicks into place.

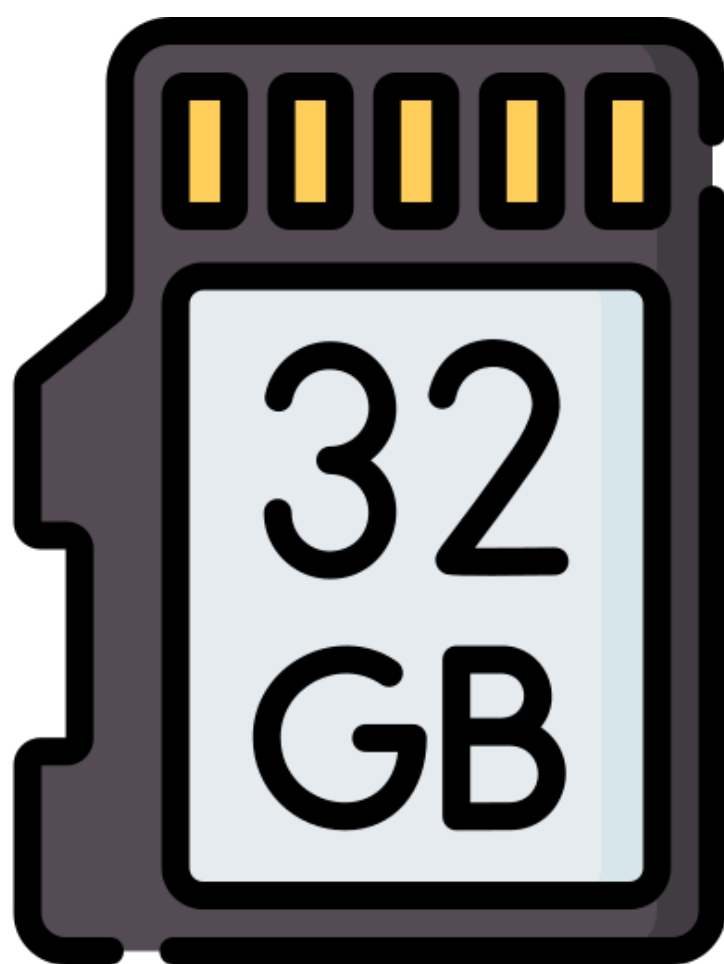

Continue

< Back

Back to  
Menu



## 4. SD Card Player

### 4.2 Switch to MicroSD card mode

1☒ Turn the knob to **ON** — the screen will light up.

2☒ Press **MODE** once to switch to **Micro SD card** mode.



Continue

< Back

Back to  
Menu



## 4. SD Card Player

### 4.3 Playback Order Settings

1☒ Repeat One → Press "**MODE**" + ①

2☒ Repeat All → Press "**MODE**" + ②

3☒ Shuffle → Press "**MODE**" + ③

Continue

< Back

Back to  
Menu



## 5. USB Stick Player

### 5.1 Plug in the USB Stick

- Maximum storage capacity for a flash drive: **32GB**.
- Supported file formats: **MP3, WAV, WMA**.
- Plug the stick in the USB port.

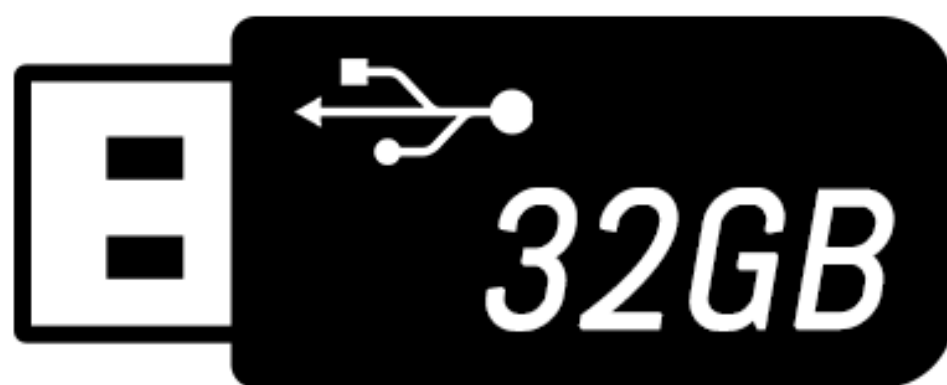

Continue



< Back

Back to  
Menu



## 5. USB Stick Player

### 5.2 Switch to Music mode

1☒ Turn the knob to **ON** — the screen will light up.

2☒ Press **MODE** once to switch to **USB Drive** mode.



Continue

< Back

Back to  
Menu



## 6. Bluetooth Speaker

### 6.1 Turn on Bluetooth

1☒ This speaker connects to phones, tablets, or computers – **not** to other speakers or headphones.

2☒ Turn on Bluetooth on your device.

#### Settings

Q Search



John Doe



Airplane Mode



WLAN

AVA-02-Meeting Room >



Bluetooth

Off >



Cellular



Personal Hotspot

Off >

Continue

< Back

Back to  
Menu



## 6. Bluetooth Speaker

### 6.2 Switch to Bluetooth mode

1☒ Turn the knob to **ON** — the screen will light up.

2☒ Press **MODE** once to switch to **BT Speaker** mode (pairing).



Continue



< Back

Back to  
Menu



## 6. Bluetooth Speaker

### 6.3 Select "Avantree PowerByte"

☒ Select the speaker from your device's Bluetooth list.

☒ Wait for connection.

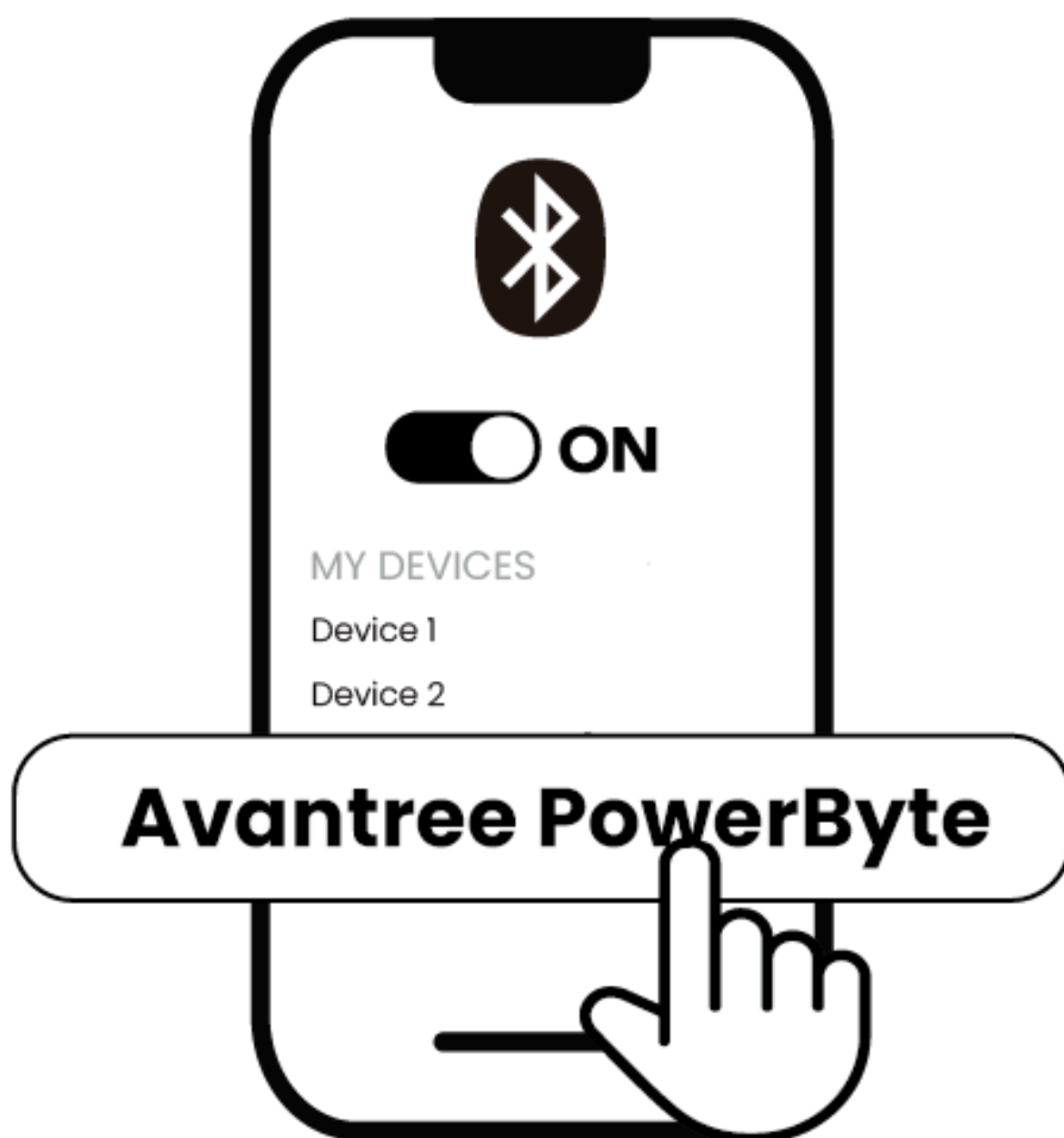

Connected

< Back

Back to  
Menu



# Navigation Guide

- Use SEEK > / < SEEK – Next or previous FM channel/track
-  – Play/pause or mute/unmute
- EQ – Change sound mode
- Knob – Adjust volume
- MODE + 0 (hold 5s) – Reset

 [View detailed button functions here ↗](#)

Continue

< Back

Back to  
Menu



# You're Ready

Enjoy your experience with **PowerByte** now!

📄 [Rate this guide, thanks!](#) ↗

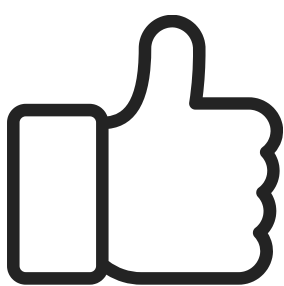

< Back

Back to  
Menu



## 9. Contact Us

We're here to help you.  
Choose an option below:

Email us at  
**support@avantree.com**

[Book a call](#) ↗

[Submit a ticket](#) ↗

[Live chat with us](#) ↗

