



Aura Loop (Dual)

Auracast TV Transmitter &
Earbuds Set



Interactive User Guide

Version 2.3



First Time Setup

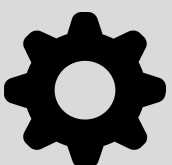

Troubleshooting

< Back



Main Menu

1. Before You Start
2. Get Sound from TV
3. TV Setup (PCM)
4. Hear TV Audio
5. Adjust Volume
6. Advanced Setup
 - Use with Hearing Aids
 - Add More Headphones
 - TV + Phone (Dual Link)
7. Troubleshooting
8. Support & Feedback

Next



1. Before You Start

Not a Bluetooth Transmitter

- The base uses Auracast™ only
- Does NOT connect to regular Bluetooth headphones

Headphones Work in 2 Modes

- Auracast (with base)
- Bluetooth (with phone)

Check Your TV

- Optical (recommended) or AUX
- HDMI-only TVs need adapter

[Next](#)[Rate This Guide →](#)



2. Get Sound from TV

1 Power on Transmitter.

Plug into power. LED turns on.

2 Connect to TV audio output:

- **OPT (Recommended)**
Best sound & most stable
- **AUX (3.5mm)**
If no optical port
- **HDMI-only TV?**
Use [HAX06](#) HDMI→Optical adapter



Not sure?

[Send us](#) a photo of your TV ports.

Next

[Rate This Guide →](#)



3. TV Setup (PCM)

Set TV audio to PCM

Check These 2 Settings

1. Audio Output

✓ **Optical /HDMI ARC**

2. Digital Audio Output

✓ **PCM (Required)**

If set to **PCM**, you're all set.



Not sure?

Search: **TV brand + PCM setting**

Next

[Rate This Guide →](#)



4. Hear TV Audio

Turn on the headphones.

Solid orange light = connected

You should hear TV sound now.

No sound yet?



*Check TV audio output and make sure TV is set to **PCM**.*



Want sound from both TV speakers and headphones?

See [TV Speaker + Headphones guide](#) ↗

Next

[Rate This Guide](#) →



5. Adjust Volume

① TV Volume

Adjust your TV volume first.

② Earbuds Volume

Use +/- on earbuds.

③ Volume Boost (if needed)

Use only if volume is still low.

⚠ Using Volume Boost first may cause distortion.

Charging

- Use dock or USB-C
- Up to 24 hrs playtime

Next

[Rate This Guide →](#)

6. Advanced Setup

6.1 Use With Hearing Aids

Aura Loop supports [Auracast-enabled hearing aids](#), but requires a firmware switch.

To use hearing aids, you must update the transmitter [via DFU](#).

- Default mode: **Headphone Mode (v0.2.7)**
- Hearing aid mode: **v0.2.6**

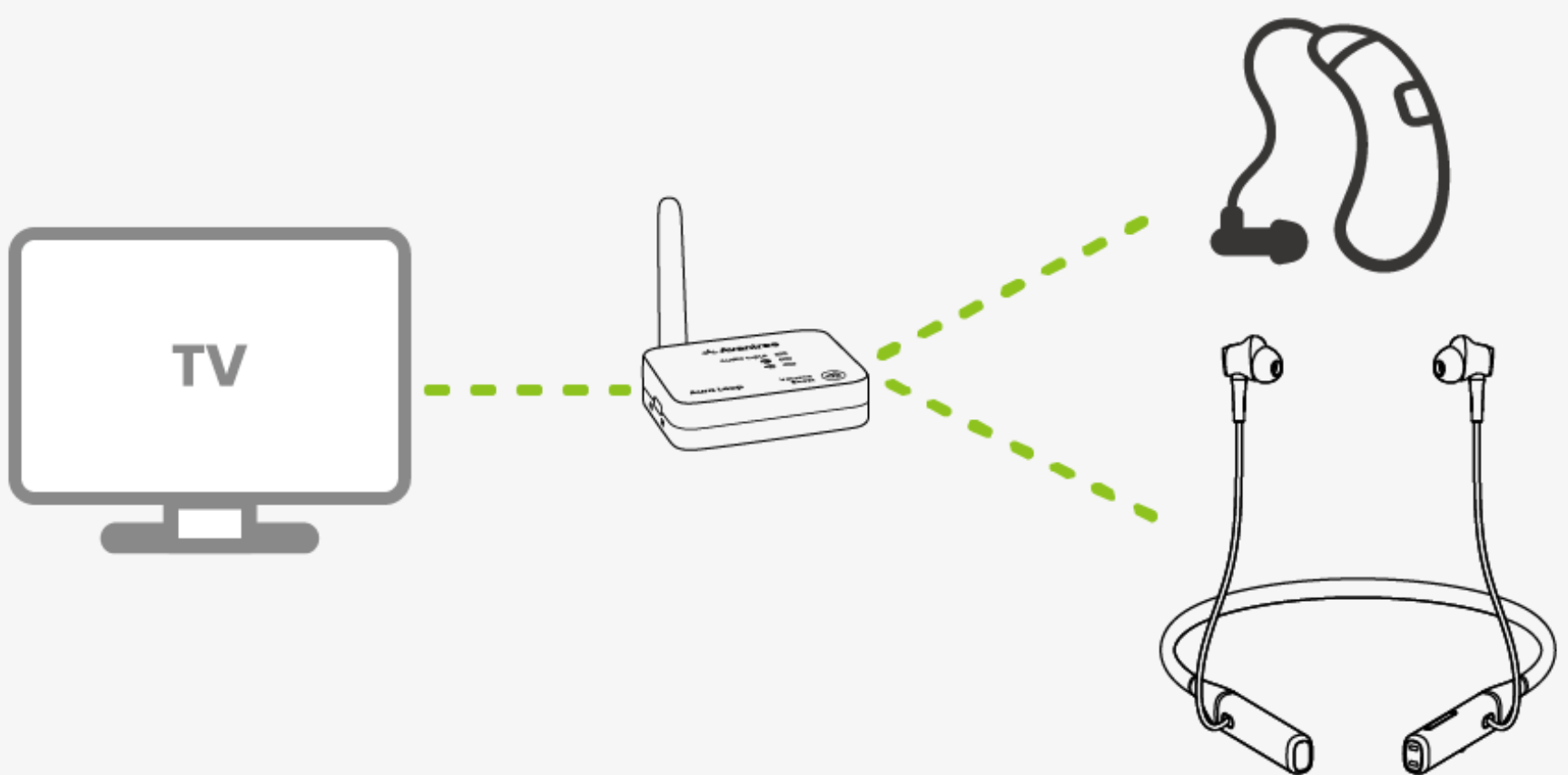
[Next](#)[Rate This Guide →](#)

6.2 Add More Headphones (*Unlimited*)

Auracast supports multiple listeners at the same time and works with many new Auracast devices.

- **Add More Loop Earbuds**

Turn on additional [Loop earbuds](#)
→ LED turns **solid orange**.

- **Compatible with Avantree Auracast devices**



Infinity NC



Aria Aura



AuraClip



ShareCast Solo

- ✓ *Avantree devices are most ready to use – turn on and listen.*
- ✓ *Use its APP for JBL, Samsung, etc.*

Next

[Rate This Guide →](#)

6.3 TV + Phone (Dual Link)

Stay connected to your phone while watching TV.

👉 **Never miss a call**

- Incoming calls pause TV audio automatically.
- TV sound resumes after the call ends.

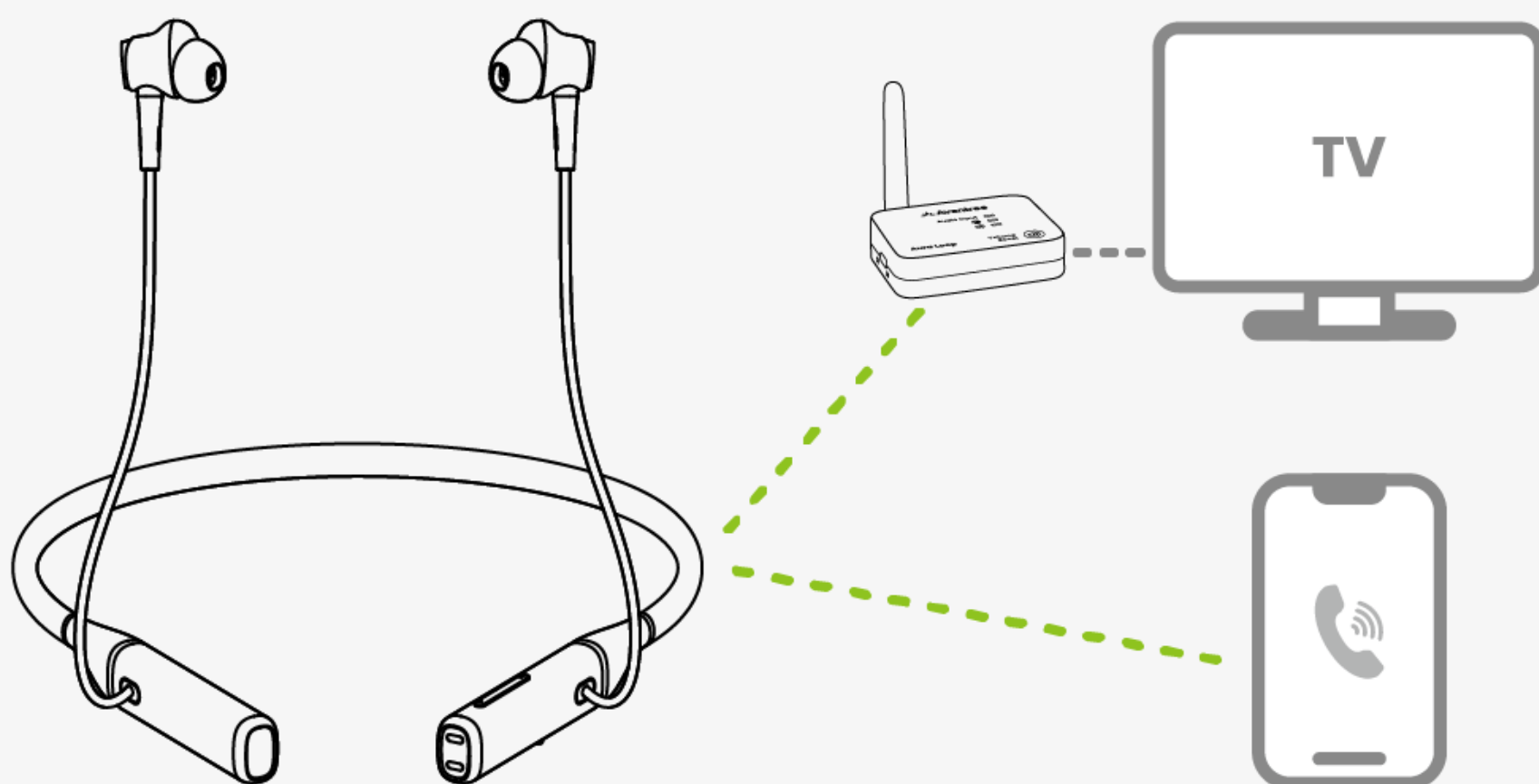
[Next](#)[Rate This Guide →](#)



7. Troubleshooting

Common Issues

- [No sound? ↗](#)
- [Sound too low? ↗](#)
- [TV Speaker not working? ↗](#)

[👉 More FAQ & Help ↗](#)

 *Still need help? [Contact support ↗](#)*

Next

[Rate This Guide →](#)

< Back



Menu

8. Support & Feedback

Agent Support

Need help? We're here.



Email



Call



Chat

Register Your Product

Extended warranty & get updates.

[Get 24M Warranty](#)

[Rate This Guide →](#)