



Audikast 4HA

Auracast Audio Transmitter
for Hearing Aids



Interactive User Guide

Version 1.8

Start Setup

< Back



Main Menu

1. Before You Start
2. Compatible Hearing Aids
3. Buttons & Indicators
4. Connect to Audio Source
5. Connect With Device
 - A. Auracast Hearing Aids
 - B. Bluetooth Headphones
6. Firmware Update
7. FAQ & Troubleshooting
8. Support & Feedback

Next

1. Before You Start

Easily stream TV audio wirelessly to your hearing aids or headphones

You can use it:

- With **Auracast-compatible hearing aids**
- With **standard Bluetooth** headphones or earbuds
- For clear, synchronized audio with simple plug & play setup



Use with Hearing Aids?
Check Compatibility first →

[Next](#)

2. Compatible Hearing Aids

Models currently supported:

- **ReSound** Nexia, Vivia, Savi
- **GN** Danalogic Extend
- **Jabra Enhance** Pro 20, Pro 30, Select 500
- **Beltone** Commence, Envision, Serene
- **Starkey** Edge AI (must be through latest Android Phone)

Not listed?

- Check with your manufacturer to confirm **Auracast-enabled**.
- Some **Phonak** hearing aids use **classic Bluetooth**, which may cause **audio delay**.

[Next](#)

3. Buttons & Indicators



A Audio Signal

✓ Solid → OK

⚠ Blinking → Audio problem

B Auracast

✓ Solid → Broadcasting

C Bluetooth

✓ Solid → Connected

⚠ Blinking → Not Connected

[👉 Full Buttons & Indicators Guide](#)

Next

< Back



Menu

4. Connect to Audio Source

Choose one option below

A

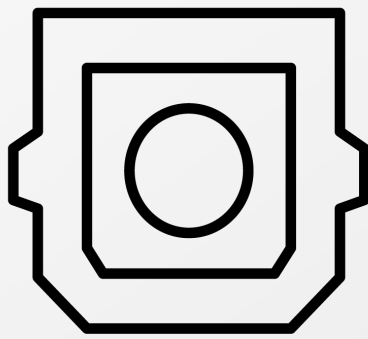

Optical

(Recommended)

B

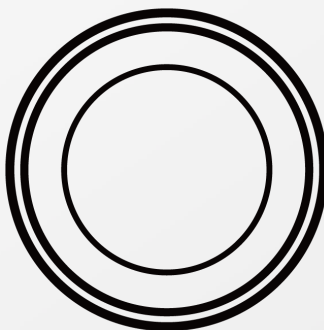

AUX

A.1 Connect Optical Cable

Plug into Transmitter (Optical) → TV (Optical Out)





Note: If using a soundbar with HDMI-ARC, unplug it.

A.2 Set TV Audio Output

Use your TV remote to adjust:

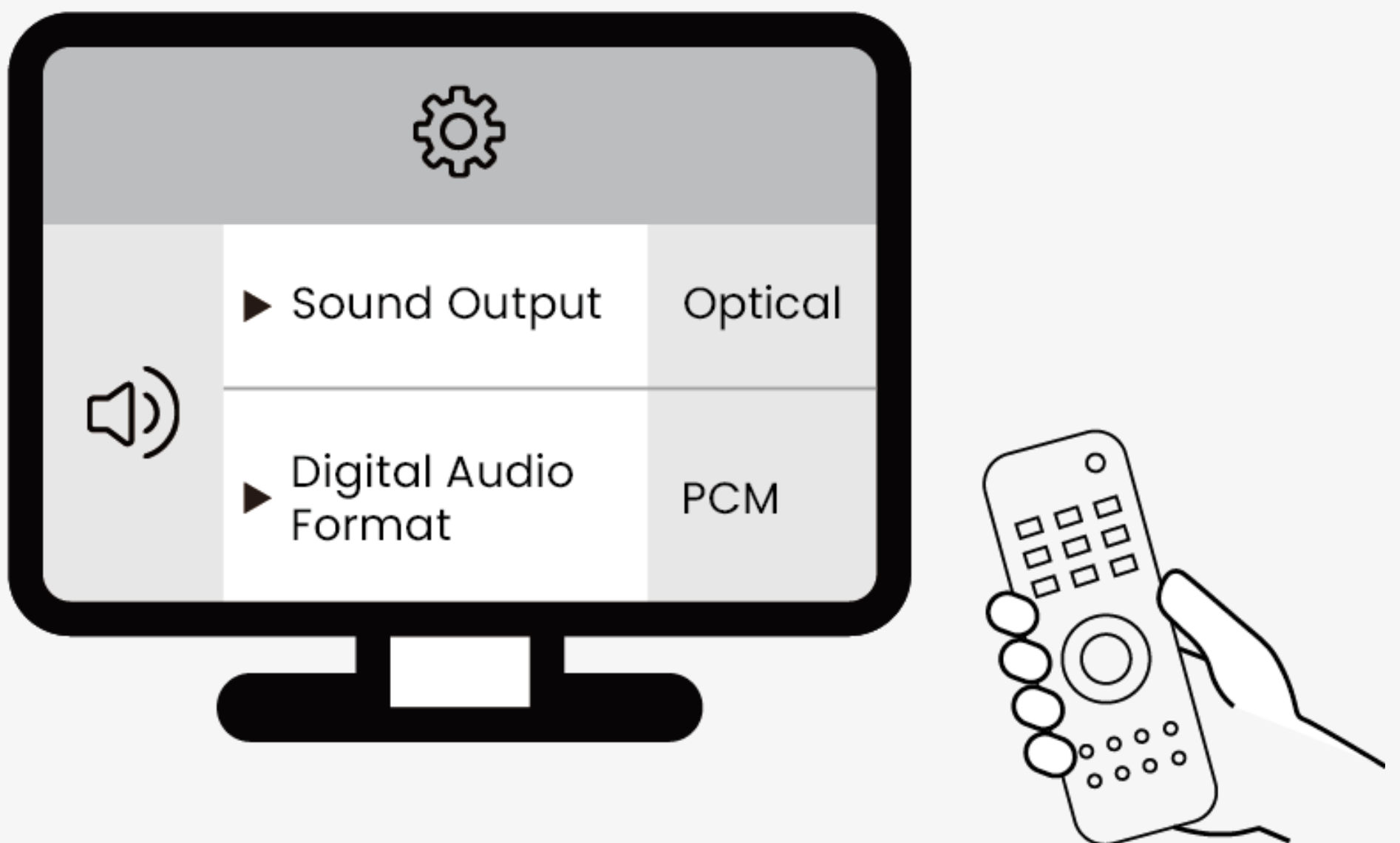
- 1 Sound Output → **Optical**.
- 2 Digital Audio Format → **PCM**.



 Set Digital Audio Format to **PCM**.
Other formats will not work.

 Not sure? Check our
[Brand-by-Brand TV Guide](#)

Next

A.3 Power Up Transmitter

- ➊ Connect Audikast 4HA to power.
- ➋ Turn it on.



✓ Audio Signal LED **Solid** → Setup is complete

⚠ Audio Signal LED **keeps flashing** →
[Check your TV audio settings](#) ↗

Next

< Back



Menu

B.1 Connect AUX Cable

Plug into Transmitter (AUX) → TV
(Headphones/Audio Out)

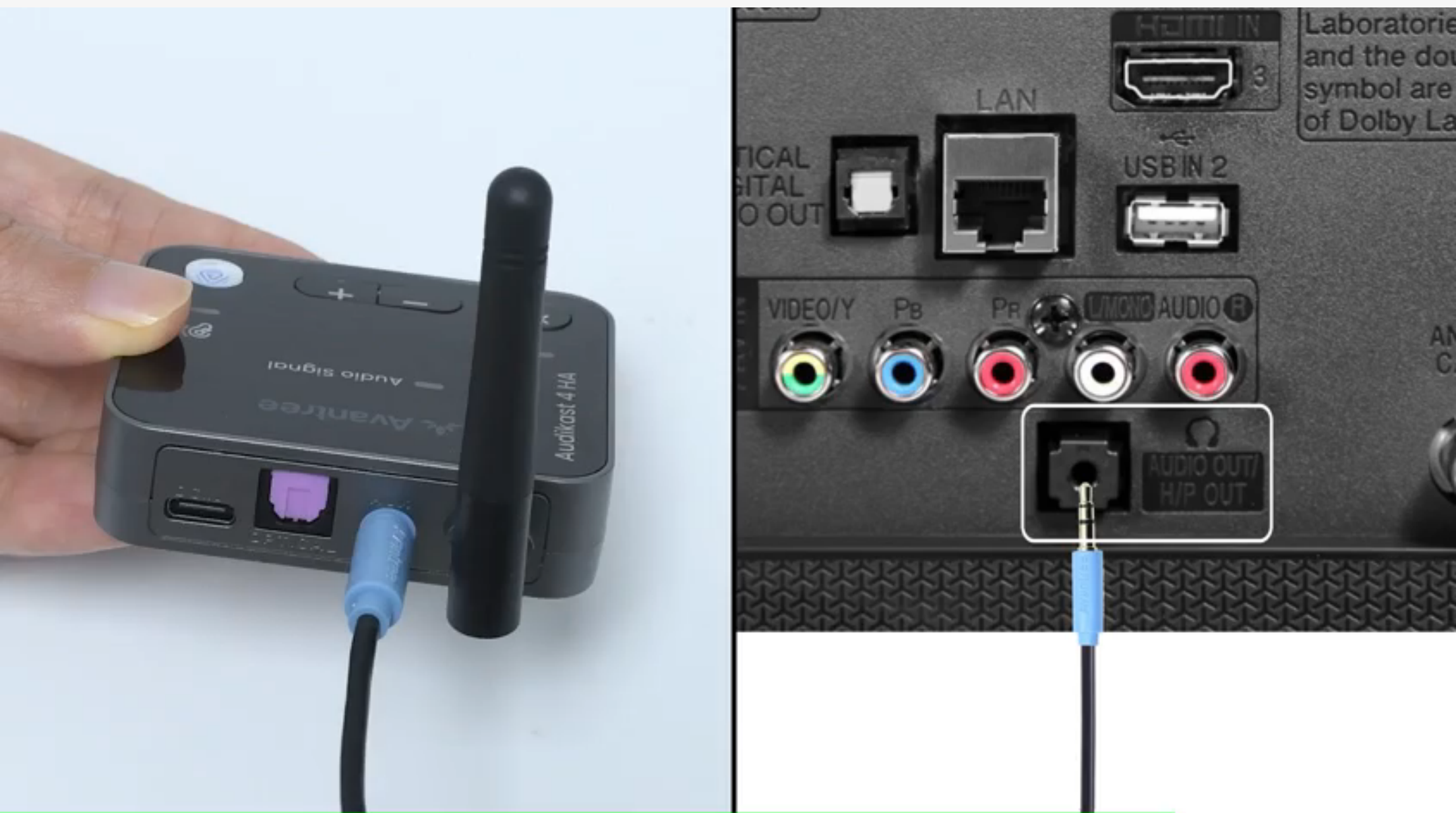

Next

B.2 Set TV Audio Output

On your TV, set the sound output to **headphones**.



B.3 Power Up Transmitter

- ➊ Connect Audikast 4HA to power.
- ➋ Turn it on.



✓ Audio Signal LED **Solid** → Setup is complete

⚠ Audio Signal LED **keeps flashing** →
[Check your TV audio settings](#) ↗

Next



5. Connect With Device

Choose how you want to use
Audikast 4HA:

A



[Auracast Hearing Aids](#)

→ Connect to Auracast-ready
hearing aids



B



[Bluetooth Headphones](#)

→ Connect to your Bluetooth
headphones / earbuds

A.1 Start Broadcasting

- 1 Turn on transmitter → Auto-enters Auracast mode.
- 2 Hold  for 3s to switch between:
 -  **White** → Hearing aids
 -  **Orange** → Headphones/Speakers



A.2 Select Your Model

These devices are confirmed to support Auracast.

Choose your model:

[ReSound](#)

Nexia,
Vivia,
Savi

[GN](#)

Danalogic
Extend

[Jabra Enhance](#)

Pro 20,
Pro 30,
Select 500

[Beltone](#)

Commence,
Envision,
Serene

[Starkey](#)

Edge AI

Note: If your device is not listed, please [contact us](#).

A.3 Choose Auracast Assistant

Your device needs an Auracast Assistant to find and join broadcasts.

Tap **either** option below to continue.



[Use Your Hearing Aid's App](#)



[Use Android Auracast Assistant](#)

Use Your Hearing Aid's App

- ❶ Pair your hearing aid with phone via Bluetooth.
- ❷ Open device manufacturer's app:
Turn on **Auracast Assistant** →
Find a broadcast → **Audikast 4HA**.
- ❸ Play audio → Enjoy with Auracast device.

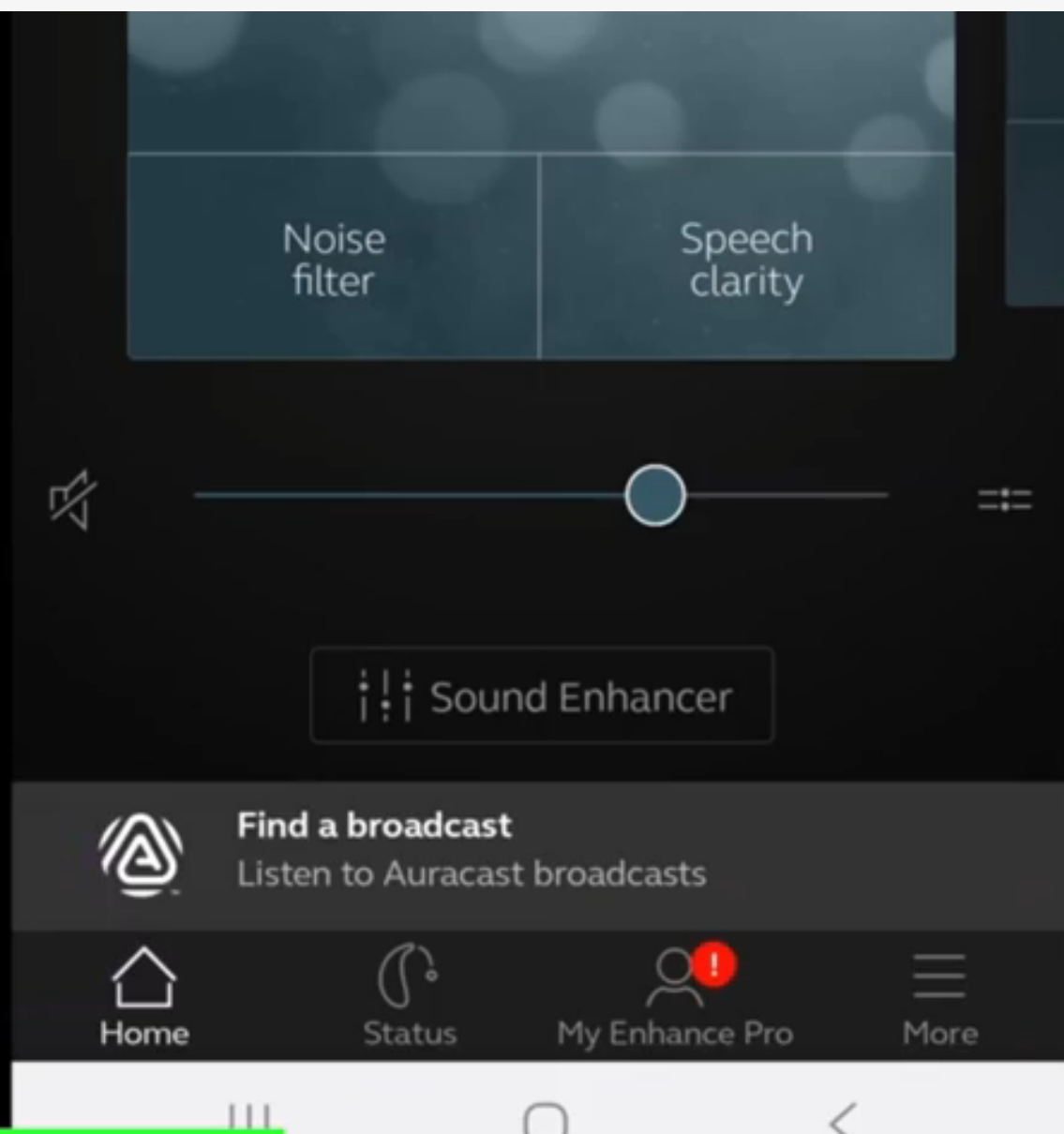



iOS does not support Auracast natively. You must use your device's App Auracast Assistant.

Next

Use Android Auracast Assistant

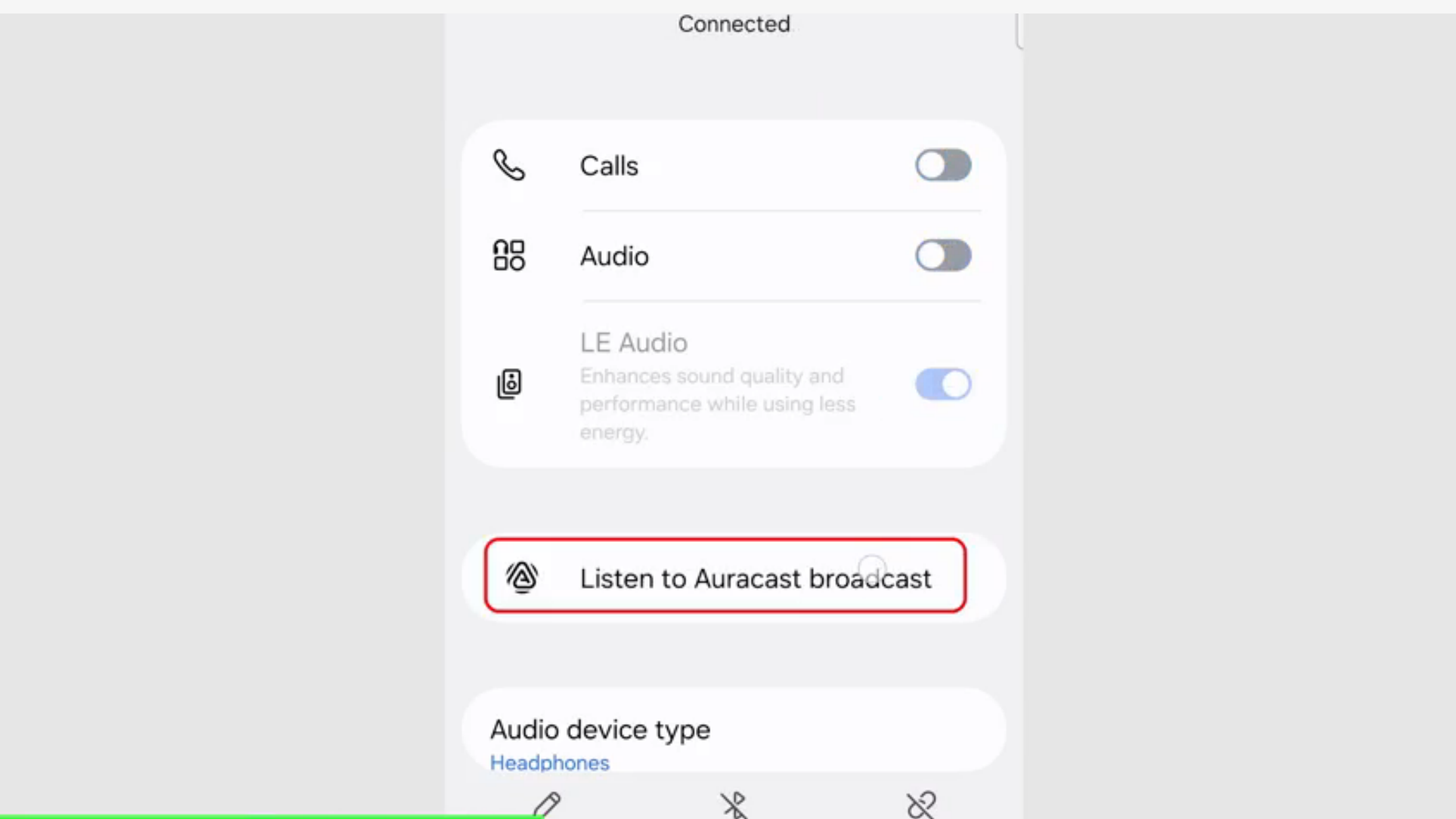
- 1 Pair your hearing aid with phone via Bluetooth.
- 2 Turn on LE Audio on Phone.
→ Tap **Listen to Auracast broadcast**
→ **Audikast 4HA**
- 3 Play audio → Enjoy with Auracast device.



 [Find a phone with Auracast Assistant support](#) (e.g. Samsung S23+, Pixel 8/9)

Next



A.4 Tip for Stable Connection

After your hearing aids are connected, turn off your phone's Bluetooth.

This prevents your phone from sending background signals that could interrupt the Auracast stream.



Need help? View [Troubleshooting Guide](#) ↗

Next

B.1 Put Transmitter in Pairing

- 1 Turn on transmitter.
- 2 Press  to switch to Bluetooth mode.
→ LED blinks **red** & **blue** (pairing).



B.2 Turn Off Phone Bluetooth

Turn off phone Bluetooth to avoid auto-reconnect and pairing issue

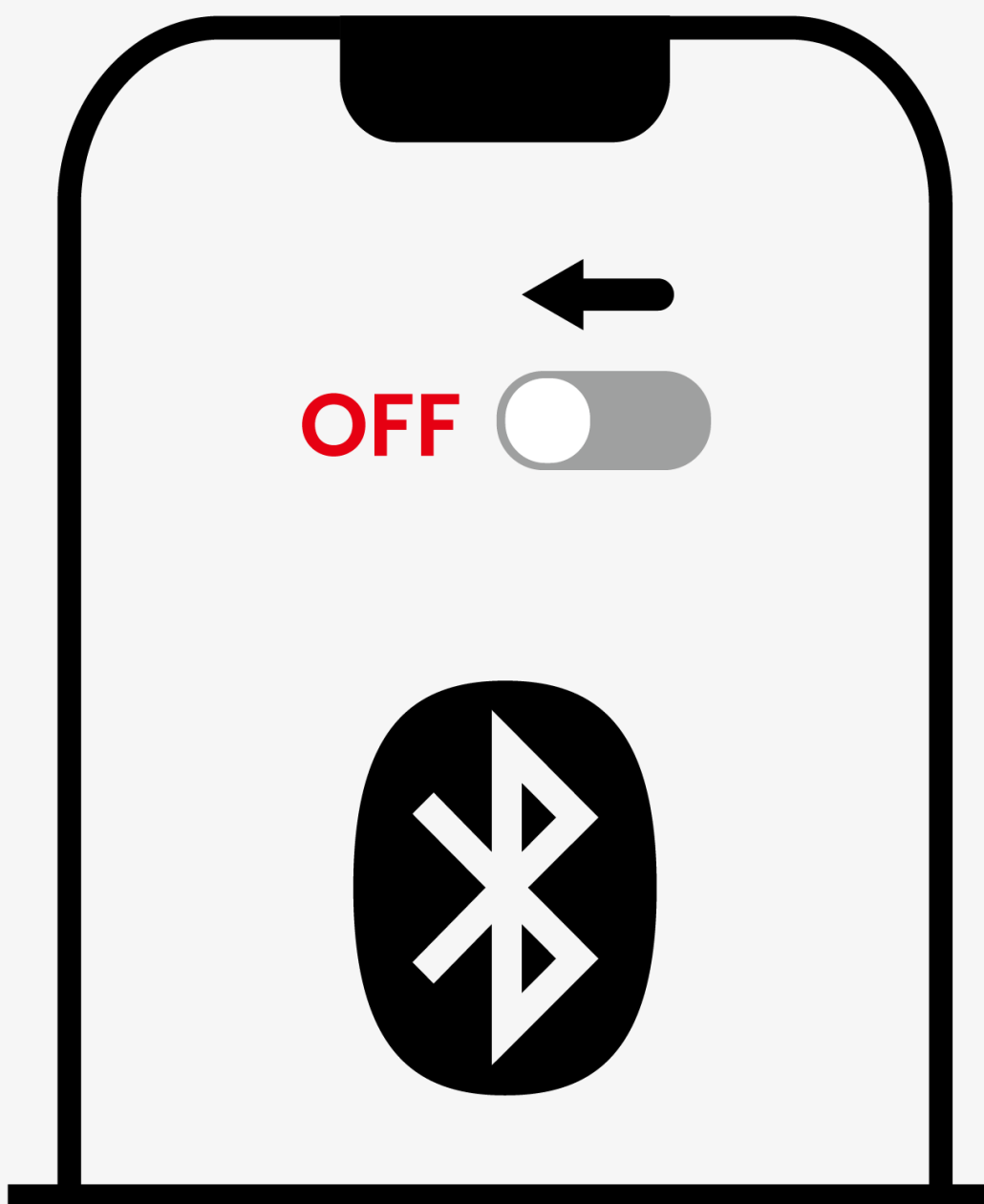

B.3 Put Headphones in Pairing

- Headphones **must be in pairing mode**.
- Usually, press & hold the main button until the light **blinks**.

Example: AirPods Pro pairing mode

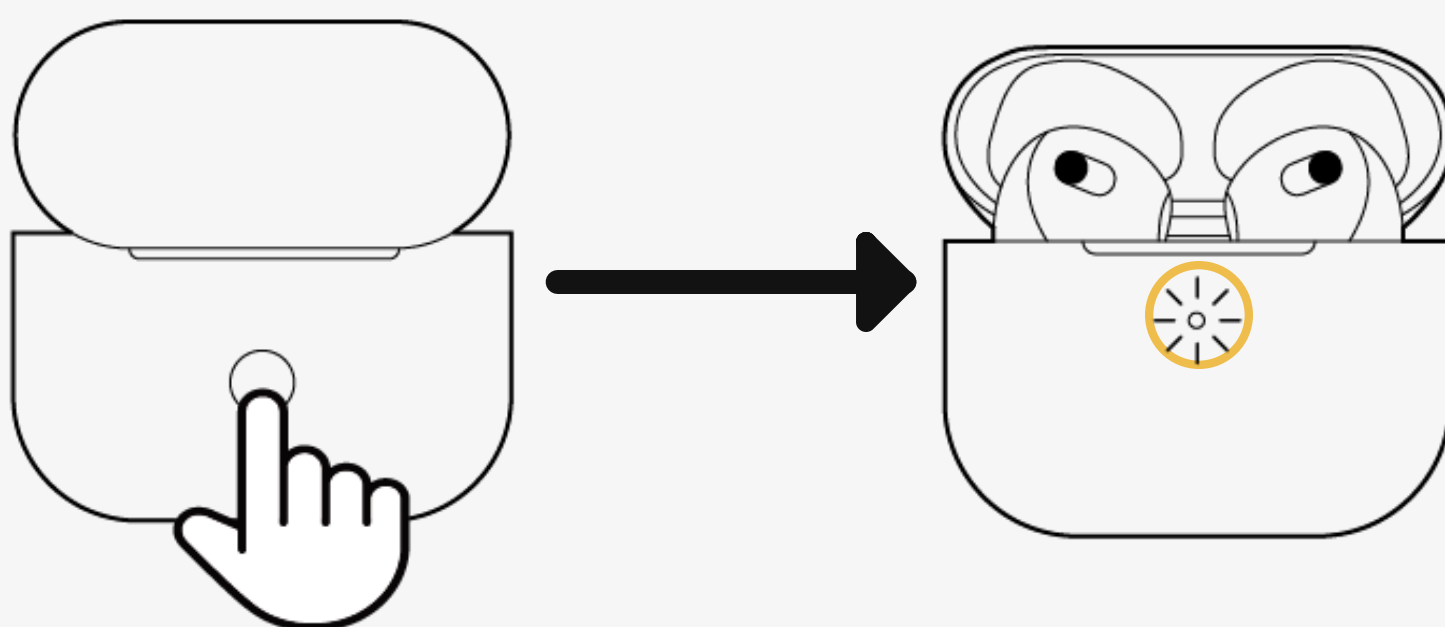

 Most failures happen when headphones are **not** in pairing mode.

 Need help? Check our [Headphone Pairing Guide](#)

Ready to Pair

B.4 Connect & Play

❶ Place headphones near transmitter.

✅ LED turns **solid blue** = **Connected**

❷ Play Audio → Enjoy audio through headphones.

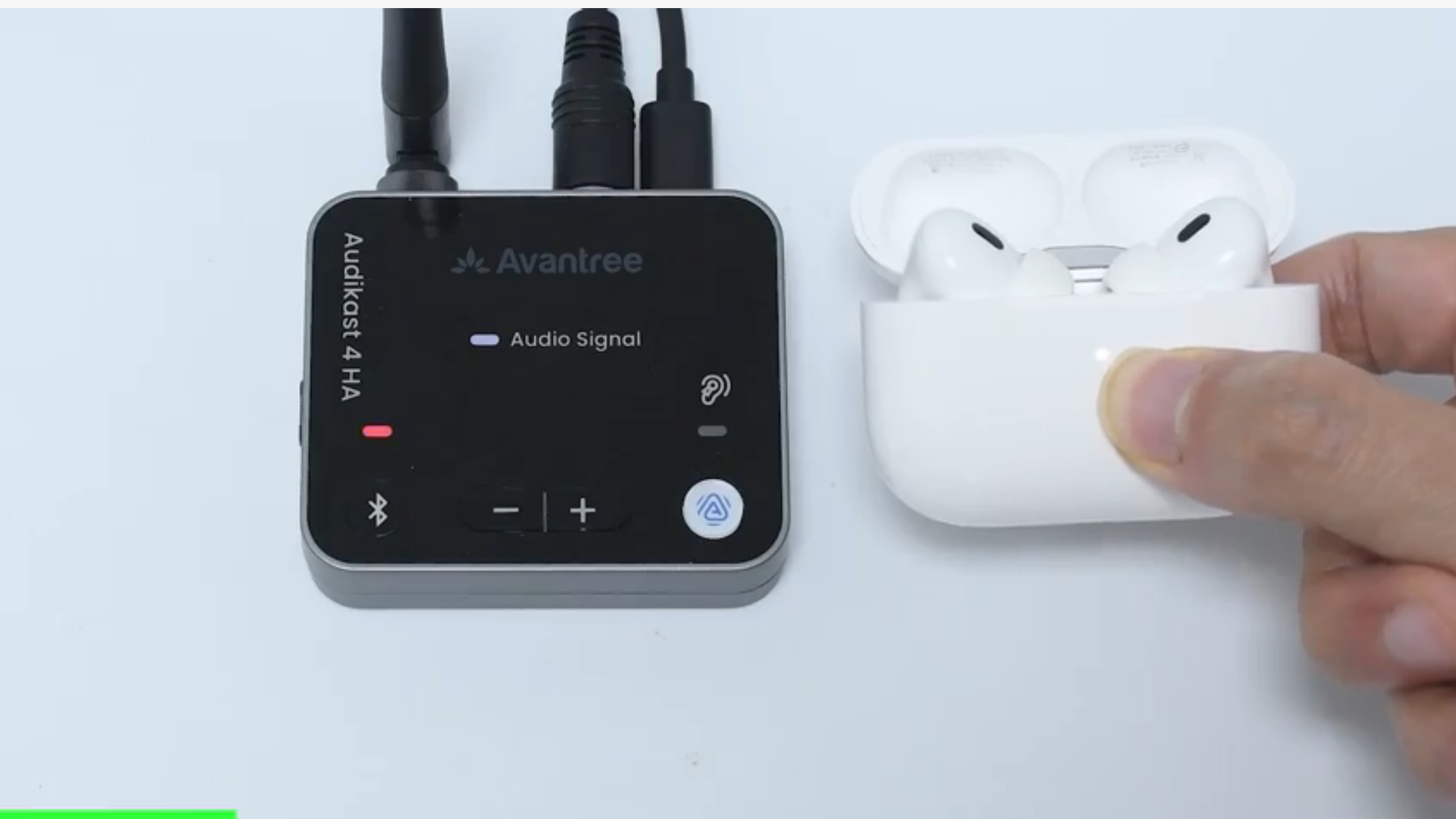

👉 Still no sound? Check our [Troubleshooting Guide](#)

Next

6. Firmware Update

Keep your device up to date for better performance and new features like encryption or password change.

- [Register your product](#) ↗ or check the [Firmware Update Page](#) ↗
- Leave your email to get notified when new firmware is available.

7. FAQ & Troubleshooting

Here are some common questions:

- [Will Sony WH-1000XM5/XM6 work? ↗](#)
- [How to reset? ↗](#)

 [More FAQ & Troubleshooting ↗](#)



8. Support & Feedback

1. Register Your Product

Extended warranty & get updates.

[Register Your Product](#)

2. Agent Support

Need help? Contact our agents.



Email



Call



Chat

3. Share Feedback

How do you feel about this guide?



Bad



Okay



Good